

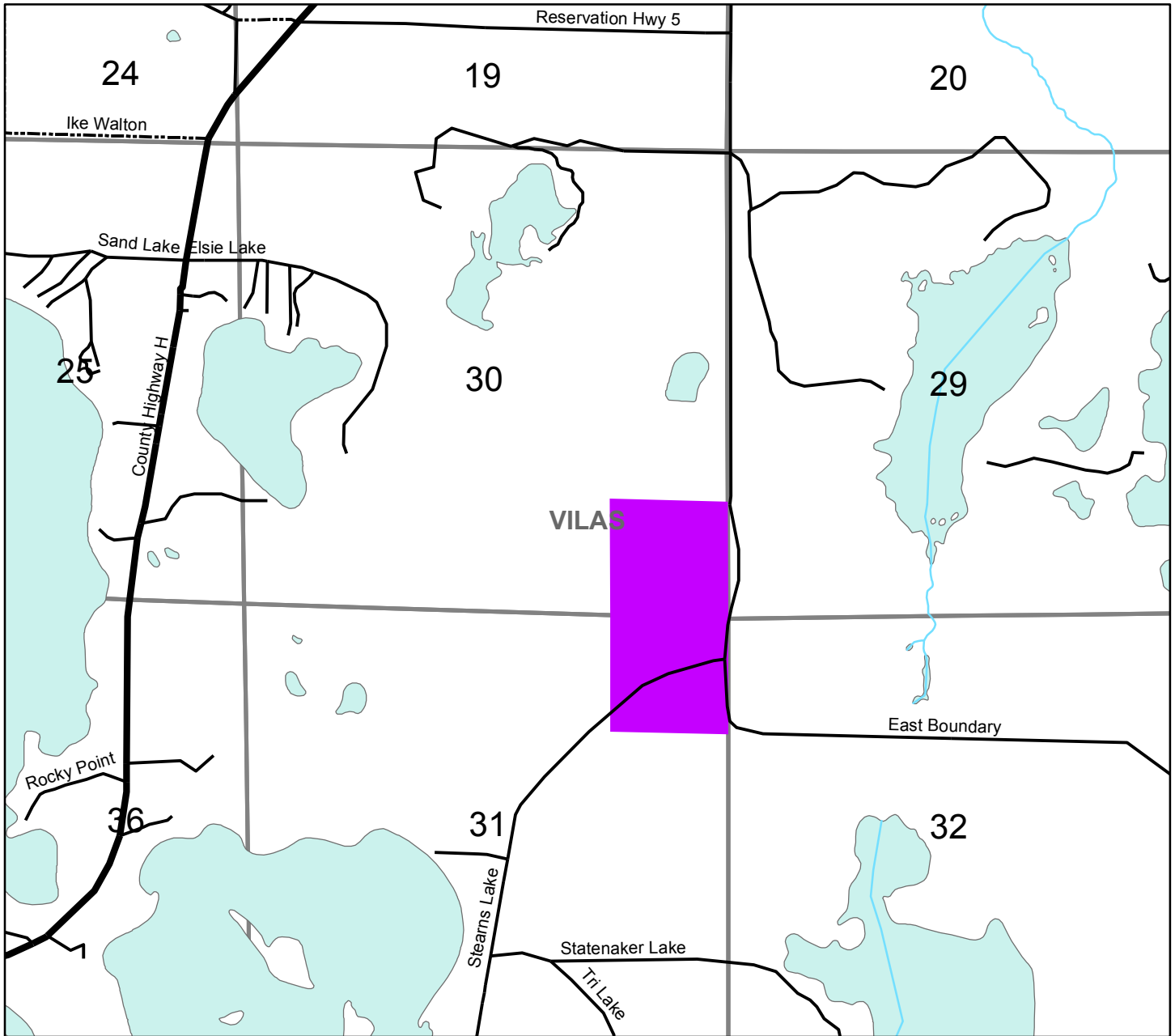



Lapointe, LLC. Ownership Map of Southwestern Vilas County  
 Cover Groups. T41N R6E, Lac Du Flambeau, Wisconsin 3/17/2016



-  - Upland Mix Cover Group ( Hard Maple, Red Pine, White Pine, Red Oak with other secondary species).
-  - Aspen Cover Group ( Dominated by Aspen with Maple and Oak with a variety of secondary species).
-  - Swamp Conifer Cover Group ( Cedar, Hemlock and Spruce with a variety of secondary species).
-  - Non-Timber Cover Group ( tag alder, open marsh, water dominated).